



Studio 202 is a commercial photography rental studio located in beautiful Old San Juan, Puerto Rico. Housed on the second floor of a wonderfully restored Spanish colonial building, the studio's production area features five balconies that create a working daylight space. Close the blinds and take advantage of the 18' ceiling to optimally light your subjects. The space also features client and conference areas for your comfort. For its natural and architectural beauty, many location shoots are produced in the immediate area, making Studio 202 the perfect base for your production team.

Contact: Chendo Pérez at 305 302.8239 or info@chendoperez.com

Prices subject to change without notice

| Studio Rental | | | Half Day (5 hrs.) | Full Day (10 Hrs.) | Hour Overtime |
|--|---|---|------------------------------|-------------------------------|--------------------------|
| All rentals require an insurance certificate endorsement | | | | | |
| Studio 202 | A | 1200sq.ft. Production Area | \$400 | \$600 | \$75 |
| Studio 202 | B | 1200sq.ft. Production, Client, and Conference Areas | \$600 | \$900 | \$100 |

Rental Equipment List

| Manufacturer | Item No. or Size | Description | Daily | Weekly | Deposit |
|---------------------------|-------------------------|-----------------------------|--------------|---------------|----------------|
| Cameras and Lenses | | | | | |
| Nikon | D4 | Camera, Battery and Charger | \$300 | \$1,200 | \$6,000 |
| Nikon | D3 | Camera, Battery and Charger | \$200 | \$800 | \$5,000 |
| Nikon | 35mm f2 af | Lens | \$25 | \$100 | \$350 |
| Nikon | 50mm f1.4 af | Lens | \$35 | \$140 | \$500 |
| Nikon | 60mm f2.8 af Micro | Lens | \$40 | \$160 | \$600 |
| Nikon | 85mm PC Micro | Lens | \$60 | \$240 | \$1,900 |
| Nikon | 17-35mm f2.8 af | Lens | \$50 | \$200 | \$1,600 |
| Nikon | 70-200mm f2.8 af | Lens | \$75 | \$300 | \$2,300 |
| Nikon | en-el4a | Battery | \$5 | \$20 | \$125 |

Lighting Equipment

| | | | | | |
|---------------|---------------------|---|------|-------|---------|
| Speedotron | 2403cx | Power Pack 2400ws | \$75 | \$300 | \$2,000 |
| Speedotron | 1500 Explorer | Battery Powered Power Pack 1500ws | \$60 | \$240 | \$1,800 |
| Speedotron | 805 | Power Pack 800ws | \$50 | \$200 | \$900 |
| Speedotron | 405 | Power Pack 400ws | \$40 | \$160 | \$600 |
| Speedotron | 202v Head | Strobe Head 2400ws w/11.5" Dish and 20' Cable | \$30 | \$120 | \$400 |
| Speedotron | 202v Extension Cord | 25' Extension Cable for 202v Strobe Head | \$15 | \$60 | \$150 |
| Pocket Wizard | Plus II | Transciever | \$20 | \$80 | \$195 |
| Sekonic | L-358 | Flash Meter w/Pocket Wizard Transmitter | \$35 | \$140 | \$400 |
| X-Rite | Passport | Color Checker | \$10 | \$40 | \$125 |

Lighting Accessories

| | | | | | |
|------------|--------|--|------|-------|-------|
| Speedotron | 22" | Beauty Dish | \$25 | \$100 | \$225 |
| Speedotron | 22" | Diffusion Sock | \$5 | \$20 | \$50 |
| Speedotron | 22" | Grid 35° | \$15 | \$60 | \$200 |
| Speedotron | 11.5" | Barndoors | \$7 | \$28 | \$75 |
| Speedotron | 11.5" | Grid 20° | \$6 | \$24 | \$70 |
| Speedotron | 11.5" | Grid 35° | \$6 | \$24 | \$70 |
| Speedotron | 7" | Snoot and Black Dish | \$5 | \$20 | \$40 |
| Photoflex | 52" | Collapsible Silver/White Reflector | \$6 | \$24 | \$60 |
| Photoflex | 52" | Collapsible Diffuser | \$5 | \$20 | \$60 |
| Photoflex | 77x77" | LitePanel Frame w/Black, White and Diffusion Fabrics | \$30 | \$120 | \$240 |
| Photoflex | 39x77" | LitePanel Frame w/Black, White and Diffusion Fabrics | \$20 | \$80 | \$200 |
| Photoflex | 39x39" | LitePanel Frame w/Black, White and Diffusion Fabrics | \$15 | \$60 | \$160 |

| | | | | | |
|-----------|-------------------|------------------------------------|------|-------|-------|
| Photoflex | Set of Frame Legs | Set of Legs for LitePanel Frames | \$5 | \$20 | \$100 |
| Photoflex | 24x32" | Medium Softbox w/Speedring | \$20 | \$80 | \$280 |
| Photoflex | 36x48" | Large Softbox w/Speedring | \$25 | \$100 | \$225 |
| Photoflex | 36x48" | Fabric Grid for Large Softbox | \$10 | \$40 | \$150 |
| Photoflex | 5' | Octodome | \$30 | \$120 | \$250 |
| Photoflex | 5' | Fabric Grid For Octodome | \$15 | \$60 | \$190 |
| Mathews | 24x30" | Black Flag | \$5 | \$20 | \$50 |
| Mathews | 24x36" | Open-End Artificial Silk Scrim | \$5 | \$20 | \$50 |
| Photoflex | Starlight Kit | Small Tungsten Light w/Sm. Softbox | \$20 | \$80 | \$200 |
| Eclipse | 52" | Umbrella, Black/White | \$5 | \$20 | \$50 |
| Eclipse | 36" | Umbrella, Black/White | \$4 | \$16 | \$40 |
| Photoflex | 36" | Umbrella, Shoot Through | \$4 | \$16 | \$40 |

Grip

| | | | | | |
|-----------|-----------------------|---|------|-------|-------|
| Manfrotto | 058B & 468MGRC2 | Tripod w/Ball Head | \$40 | \$160 | \$700 |
| Manfrotto | 475 & 141rc | Tripod w/Three Way Head | \$30 | \$120 | \$400 |
| Manfrotto | 131D | Side Arm for Tripod | \$6 | \$24 | \$70 |
| Manfrotto | 2983 | 108" Background Pole | \$7 | \$28 | \$85 |
| Manfrotto | 2960D | Background Pulley Set | \$30 | \$120 | \$420 |
| Manfrotto | Background Hook Set | Background Support with Super Clamps | \$7 | \$28 | \$90 |
| Manfrotto | 10.9' | Air Cushioned Steel Stand w/casters | \$25 | \$100 | \$300 |
| Manfrotto | 12' | Air Cushioned Light Stand | \$10 | \$40 | \$140 |
| Mathews | 40" C-Stand Hollywood | Century Stand w/Arm and Griphead | \$15 | \$60 | \$150 |
| Manfrotto | 9' | Heavy Duty 3-Section Boom with Counter Weight | \$15 | \$60 | \$170 |
| Manfrotto | 41" | Mini Boom with Counter Weight | \$5 | \$20 | \$50 |

| | | | | | |
|-----------|---------------|-------------------------------------|------|------|-------|
| Manfrotto | 032SET | Autopoles, Pair | \$20 | \$80 | \$225 |
| Manfrotto | Autopole Legs | Base for Autopole, Pair | \$15 | \$60 | \$200 |
| Manfrotto | Super Clamp | Super Clamp with Standard Stud | \$4 | \$16 | \$30 |
| Manfrotto | Spring Clamp | 175 Clip Clamps | \$3 | \$12 | \$20 |
| General | A-Clamp | Small or Large Pony Clamp | \$1 | \$4 | \$5 |
| Photoflex | T-Clamp | For LitePanel Frames | \$3 | \$12 | \$20 |
| Manfrotto | 012B | Short Background Light Stand | \$5 | \$20 | \$50 |
| Impact | 15lbs. | Sandbag | \$3 | \$12 | \$25 |
| Mathews | Pancake | Apple Box | \$3 | \$12 | \$25 |
| Mathews | 1/4 | Apple Box | \$3 | \$12 | \$25 |
| Mathews | 1/2 | Apple Box | \$3 | \$12 | \$25 |
| Mathews | Full | Apple Box | \$3 | \$12 | \$25 |
| General | 50' | Heavy Gauge Electric Extension Cord | \$3 | \$12 | \$25 |

Computer Equipment and Software

| | | | | | |
|--------------|----------|---|-------|-------|---------|
| Apple | 24" iMac | Computer, with Photoshop CS6, Lightroom 5, Aperture | \$150 | \$600 | \$2,500 |
| Tether Tools | 16' | Orange Tether Cord | \$5 | \$20 | \$50 |

Miscellaneous

| | | | | | |
|-----------|---------------|----------------------------|------|------|-------|
| Jiffy | Steamer | Commercial Garment Steamer | \$15 | \$60 | \$260 |
| General | Wardrobe Rack | Rolling Wardrobe Rack | \$8 | \$32 | \$125 |
| General | Ironing Board | Ironing Board | \$5 | \$20 | \$50 |
| General | Iron | Steam Iron | \$5 | \$20 | \$60 |
| Seabreeze | Turbo-Aire | Studio Fan w/Stand | \$15 | \$60 | \$300 |
| Motorola | Walkies | Two-Way Radio | \$8 | \$32 | \$100 |

| | | | | | |
|---------|----------|-----------|-----|------|-------|
| General | Bullhorn | Megaphone | \$8 | \$32 | \$100 |
|---------|----------|-----------|-----|------|-------|

Expendables - Purchase

| | | | |
|---------|-----------------------|---|------|
| Savage | 9' Black, Grey, White | Seamless Paper Background Roll 12yds. - sold per foot | \$7 |
| General | 2" Black or White | Gaffer's Tape - roll | \$30 |
| General | 4x8' Black or White | 1/4" Foamcore Panels | \$30 |
| General | 32x40" Black or White | 1/4" Foamcore Panels | \$12 |
| General | Package of 12 | C-47s | \$4 |
| Rosco | 20x24" | Assorted Gels | \$10 |
| Rosco | 17" Roll | Polarizing Filter - sold per foot | \$20 |
| Rosco | 12" Roll | Cinefoil - sold per foot | \$3 |



Floorplan

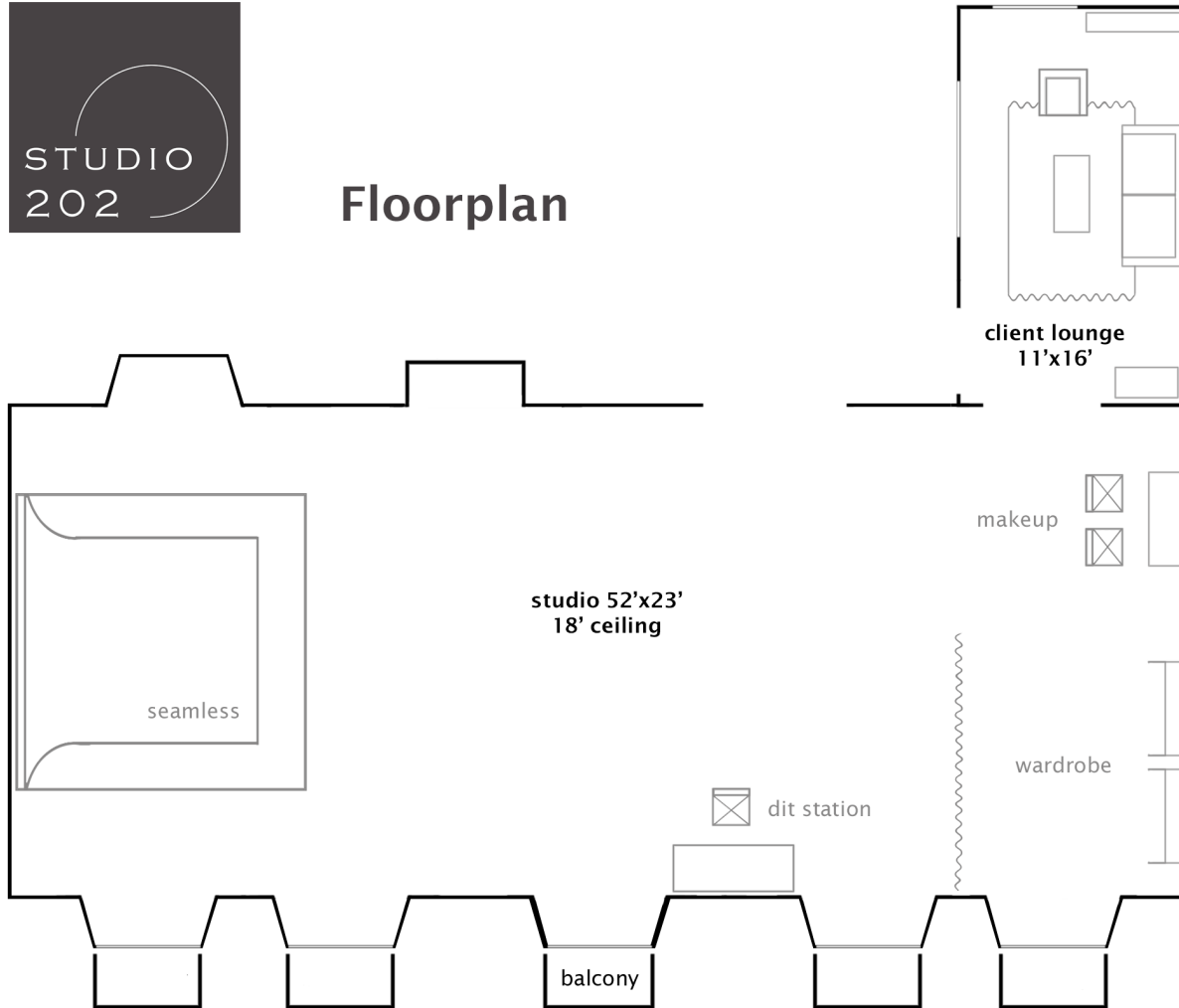

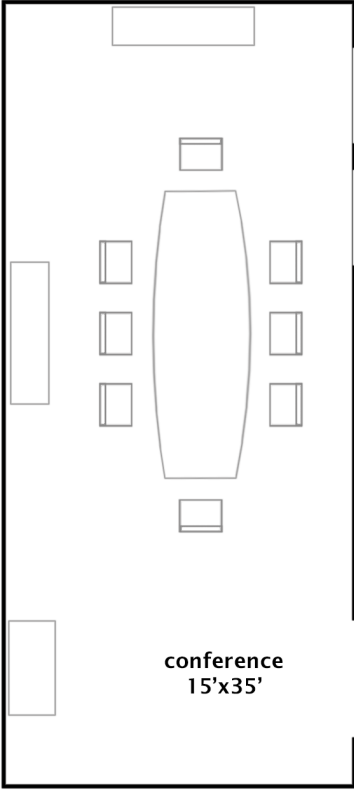

conference
15'x35'